

# FIX-A-LOO



2 YEAR WARRANTY

**This warranty runs for two years from the date of purchase.**

Our products come with guarantees that cannot be excluded under the Australian Consumer Law. You are entitled to a replacement or refund for a major failure and for compensation for any other loss or damage. You are also entitled to have the goods repaired if the goods fail to be of an acceptable quality and the failure does not amount to a major failure.

**What is covered:**

This warranty covers the product for domestic use only. The warranty covers any defects in materials or workmanship with the exception of the reasons stated below.

**What is not covered:**

This warranty does not cover wear and tear to working parts, misuse or abuse. It does not cover discolourations due to exposure or cleaning chemicals.

**Claim procedure:**

If you believe you have a legitimate claim, please contact FIX-A-TAP Australia via our website at [www.fixatap.com.au/warranty](http://www.fixatap.com.au/warranty) to complete the warranty claim form. Alternatively you can contact our office on 02 9476 7400.

**Any written correspondence should be sent to:**

FIX-A-TAP Australia Pty Ltd,  
PO Box 200,  
Wahroonga NSW 2076

Please keep your receipt for proof of purchase.

PLUMBCONNECT  
PLUMBERS REGISTRY

**Need a plumber?**

To find a plumber in your area, consult our PlumbConnect Registry using the QR code or via our website:

[www.fixatap.com.au/find-a-plumber](http://www.fixatap.com.au/find-a-plumber)



FIX-A-TAP® AUSTRALIA PTY LTD  
The Ultimate Plumbing Solution  
PO Box 200 Wahroonga NSW 2076  
[www.fixatap.com.au](http://www.fixatap.com.au)  
Made in China  
© 2021 FIX-A-TAP



# EVERYDAY TOILET SEAT

CODE: 235770

## INSTALLATION INSTRUCTIONS

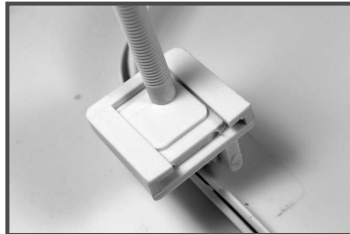
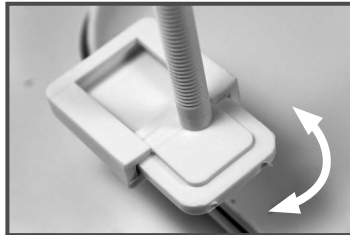
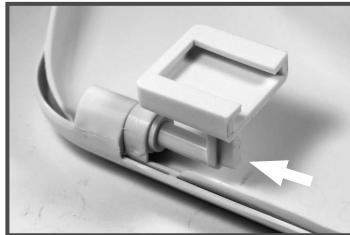
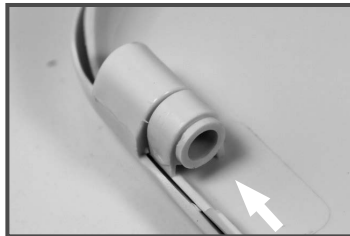
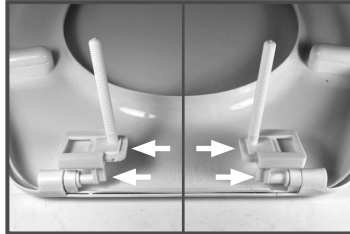

1. Brackets are always inserted from the inside facing outwards on both sides. Each side should reflect the other. You can choose how you want to place your bolts depending on the location of the holes in your pan, however both sides should remain symmetrical. (IE if your left bolt has the stem in the top left corner, then your right bolt should fit opposite with the stem in the top right corner).

2. The hinge has a hole through it. The bracket has a cylindrical piece to slide into this hole.

3. Slide the cylindrical part of the bracket into the hinges as shown. The brackets must be attached from the inside pointing out, however you can use either piece (depending on whether you want your seat to sit slightly forward or backward).

4. Slide the bolt into the bracket. This bolt can be fitted 4 ways to best suit the placement of the holes in your pan. Place the 2nd bolt in the other side as a mirror image. If the bolt placement is not symmetrical, the seat may sit unevenly on the pan.

5. With both bolts in place and symmetrical, try to fit the seat to the pan holes. The bolts can be slid side to side slightly to fit. If the bolts are too wide for the holes, remove them, and rotate to place the stem on the inner corner.

6. When seat has been placed into the pan, on the underside of your pan, add the washer (flat side up), then add the nut as shown (curved side up). Tighten nut to hold seat firmly.

## MAINTENANCE CLEANING INSTRUCTIONS

Clean with warm soapy water or a household detergent using a soft cloth or sponge. Do not use bleach or a harsh chemical based cleaner. Do not use a scourer as this may damage the finish.